

# Linea Bellagio



**LB-300**

[www.lineabellagio.com](http://www.lineabellagio.com)

C-TECH-I is proud to present its newest collection, "Linea Bellagio", an exclusive new generation of sinks specifically designed for all solid surface materials, including Quartz and Granite. Linea Bellagio sinks have been designed to integrate and install into your countertop as an under-mount. This feature minimizes bacteria entrapment, makes cleaning easier and brings the latest style into your new kitchen. Thank you again and enjoy your new sink from "Linea Bellagio" by C-TECH-I.



## FEATURES

|                     |  |
|---------------------|--|
| Model #             | LB-300                                   |
| Description         | DOUBLE BOWL KITCHEN SINK                 |
| Material            | 18/10 304 STAINLESS STEEL                |
| Color               | STAINLESS STEEL                          |
| Mounting options    | UNDER-MOUNT                              |
| Finish              | BOWLS AND SURFACE BRUSHED                |
| Thickness           | 18 GAUGE. ALSO AVAILABLE IN 16 GAUGE     |
| Sound proofing      | 10 POINT SOUND PAD SYSTEM                |
| Construction type   | 2 PIECE CONSTRUCTION                     |
| Construction method | PRESSED 2 TIMES                          |
| Warranty            | LIMITED LIFETIME                         |
| Overflow            | NO                                       |
| Drain size          | 3 5/8", STANDARD USA, CA AND EUROPE SIZE |
| Certifications      | CAN/CSA-B45/ANSI-A112.19/ANSI-Z124/MASS  |
| FGP Compliant       | YES                                      |
| Fits cabinet size   | MADE FOR CABINETS 33" AND LARGER         |

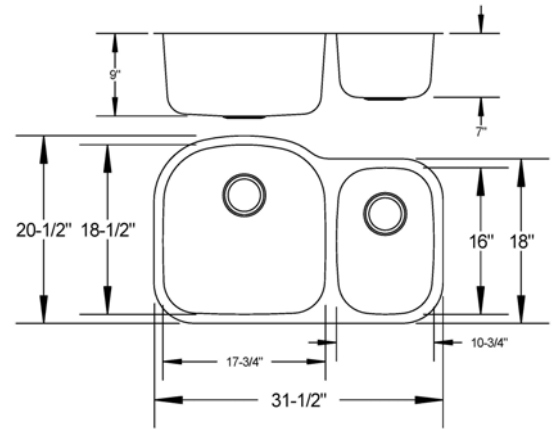

## INCLUSIONS:

Your Linea Bellagio sink includes the following accessories,  
Paper template for cut-out  
Mounting hardware

## OPTIONAL ACCESSORIES:

The following accessories are available for your sink,



## RESOURCES:

Installation instructions [www.specs.ctechi.com/sinkinstall.pdf](http://www.specs.ctechi.com/sinkinstall.pdf)  
Cleaning instructions [www.specs.ctechi.com/cleaning.pdf](http://www.specs.ctechi.com/cleaning.pdf)  
Warranty information [www.specs.ctechi.com/warranty.pdf](http://www.specs.ctechi.com/warranty.pdf)  
DXF file [www.specs.ctechi.com/lb-300.dxf](http://www.specs.ctechi.com/lb-300.dxf)

For your protection and to insure the highest quality and standards, all C-TECH-I products meet or exceed one or more of the regulatory certification marks for the USA, Canada and Europe.



**C-TECH-I**  
Unique elegance and style